

SECTION	PAGE NO.
BUMPERS, FRONT & REAR	01
GRILLE, HEATING & COOLING	01
BODY & CHASSIS	02
UNDER HOOD	03
ELECTRICAL	03
BRAKES/TRANSMISSION	06
WINDOWS/DOORS	07
FUEL SYSTEM	09
INTERIOR	10
TRUNK	10
FACTORY SHOP MANUALS	10
ADHESIVES & REMOVERS	10
ORDERING & GENERAL INFO	11
ORDER FORM	12

**RUBBER**  
*the Right Way*

### STONE DEFLECTOR - REAR BUMPER

PART#	PIC	DESCRIPTION	YEAR	PRICE
<b>Add \$25.00 Crate Charge for Stone Deflector</b>				
1M-17832-A		- Rear (3) piece set	49-51	35.15 set

### LICENSE PLATE PARTS

PART#	PIC	DESCRIPTION	YEAR	PRICE
7RA-13568	(K)	License Plate Light Lens to Housing Seal	49-51	1.90 ea.



### RADIATOR AIR DEFLECTOR & SEALS

PART#	PIC	DESCRIPTION	YEAR	PRICE
RA-3	(K)	Radiator Air Deflector to Top of Radiator Seal - (3) pc. set	49	75.00 ea.



## 100% SATISFACTION GUARANTEED!!!

- Made with original FORD tooling for a factory fit.
- Money back guarantee
- Absolutely NO re-stocking fees!



**RUBBER**  
*the Right Way*

CALL (866) 789-7879  
or EMAIL [sales@rubbertherightway.com](mailto:sales@rubbertherightway.com)

### HEATER & FRESH AIR SYSTEM PARTS

PART#	PIC	DESCRIPTION	YEAR	PRICE
0M-8725-A	(M)	Fresh Air Duct Connector Clamp - 4" - (4) per car	50-51	3.80 ea.
8M-7001878	(N)	Ventilation Air Duct Connector Hose - 4" w x 4" I.D.	49-51	14.25 pr.
8A-7001862-S	(O)	Air Valve Damper - rubber Only Must drill out spot - welds & replace the cracked rubber; Complete w/ screws to put back together	49-50	14.25 pr.
8M-18570-A	(Q)	Fresh Air Valve to Dash Rubber Gasket - 3 required per car - 2 required per car	49 50-51	3.80 ea.
0M-18570-A		Heater Core Housing to Dash Gasket - 3-7/8" x 6-15/16"	50-51	8.00 ea.
0M-18570-B		Fresh Air Hot Water Heater Blower Housing Gasket	50-51	22.50 ea.
8M-7001928		Air Ventilator Rear Duct Spring Rubber Seal	50-51	4.75 pr.
1A-13305	(R)	Fresh Air Control Lever Knob - Black - (2) per car	50-51	5.70 ea.

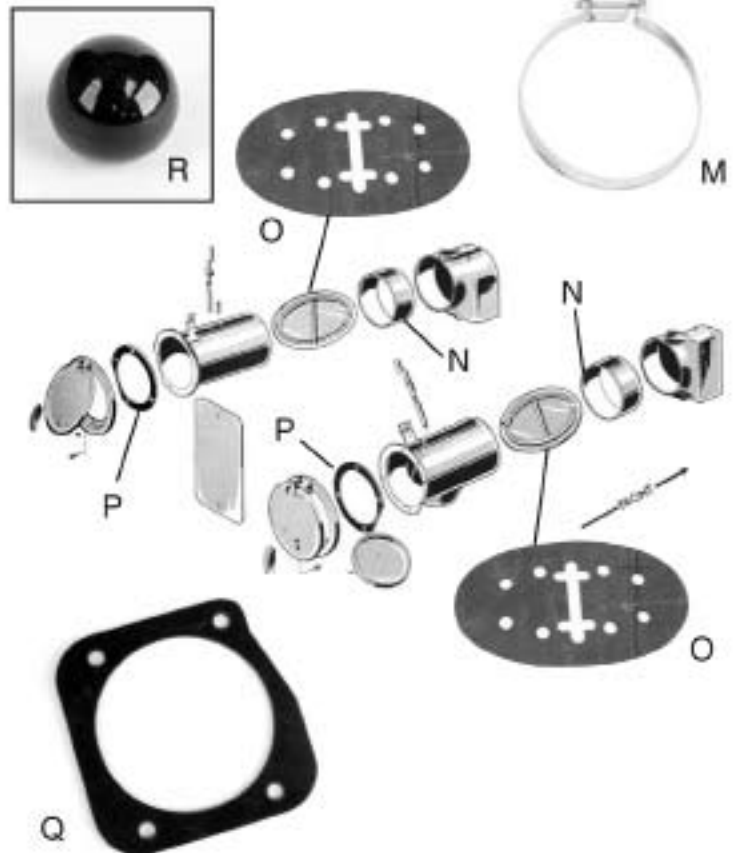

### BODY TO FRAME PAD KIT

PART#	PIC	DESCRIPTION	YEAR	PRICE
<i>Includes Installation Instructions</i>				
8M-5001		<u>Body to Frame Pad Kit</u>	49-51	38.00 kit

### ANTI-SQUEAK

PART#	PIC	DESCRIPTION	YEAR	PRICE
8M-16070-A		<u>15 Foot Roll</u>		19.00 roll

- Fits the Following:

- Clutch Shield to Frame - 36" - 1949-51
- Front Bumper Stone Deflector - 36" - 1949
- Front Fender Apron Splash Panel - 36" - 1949-51
- Cowl Side Panel to Fender Filler - 36" - 1949-51
- Front Fender Apron Splash Panel - 10-1/2" - Outer - 1949-51
- Front Fender Apron Splash Panel - 14" Front - 1949-51
- Clutch Pedal Shield to Dash Panel - 16" - 1949-51
- Clutch Shield to Frame - 8" - 1949-51
- Cowl Side Panel to Fender Filler - 10-1/4" - 1949-51



### FENDER COWL SEALS

PART#	PIC	DESCRIPTION	YEAR	PRICE
0M-16110	(K)	<u>Front Fender to Cowl Seals</u>	50-51	19.00 pr.

### FENDER SKIRTS

PART#	PIC	DESCRIPTION	YEAR	PRICE
01A-18990	(F)	<u>Fender Skirt Rubber</u> - for Original Skirts - Rubber	40-51	9.50 pr.



### DOOR HANDLES - OUTSIDE

PART#	PIC	DESCRIPTION	YEAR	PRICE
<b>NO BUTTONS, PADS, OR HARDWARE INCLUDED</b>				
0M-7222428		<u>Outside Door Handle Pad Set</u> - (4) pieces - Does (2) handles	50	8.55 kit
1M-7222428		- All models	51	8.55 kit
MP 1009-O	(H)	- All models except wagons	49	11.15 pr.



### DOOR RELATED PARTS

PART#	PIC	DESCRIPTION	YEAR	PRICE
8A-7021850-B	(I)	<u>Door Lock Button</u> - Gray	49-51	5.70 ea.
8M-7221999	(J)	<u>Door Lock Button Grommet</u> - All Except Wagon	49-51	2.85 ea.
8A-7021985-S	(K)	<u>Door Lock Cylinder Assembly</u> to Door Pads	49-51	3.80 pr.
B-7023501	(L)	<u>Door Check Arm Bumper</u>	49-51	0.95 ea.



# RUBBER

*the Right Way*

## QUESTIONS?

CALL (866) 789-7879  
or EMAIL [sales@rubbertherightway.com](mailto:sales@rubbertherightway.com)

### HOOD BUMPERS

PART#	PIC	DESCRIPTION	YEAR	PRICE
8M-16761	(K)	<u>Hood Bumper Kit</u> - (6) pcs.	49-51	7.60 kit



### HOOD & RELATED PARTS

PART#	PIC	DESCRIPTION	YEAR	PRICE
8M-16740		<u>Cowl Lacing Kit</u> - Complete with Special Tacks	Mercury 49-51	7.60 ea.
8M-16897-B		<u>Hood Safety Catch Spring &amp; Pin</u>	49-51	7.15 ea.

### COWL PANEL TO HOOD SEAL

PART#	PIC	DESCRIPTION	YEAR	PRICE
8M-7002074-PR		<u>Top Outside Corner of Cowl to Hood Seal</u> - Left & Right Side	49-51	9.50 ea.



### BATTERY TRAY & RELATED PARTS

PART#	PIC	DESCRIPTION	YEAR	PRICE
51A-5165-A	(K)	<u>Battery Hold-Down Bracket</u> - Like Original - 10 1/2" x 7 1/4"	42-53	9.50 ea.
8M-5175-AS	(L)	<u>Battery Hold-Down Clamp Kit</u> - Includes 2 each of: nuts, rubber washers, metal washers, & 5 1/4" long clamps	49-53	9.50 kit
8M-5175-B	(L)	<u>Battery Hold-Down Clamp Kit</u> - Includes 2 each of: nuts, rubber washers, metal washers, & 3 3/4" long clamps	49-53	9.50 kit



L



### PARK LIGHT - MERCURY 1949

PART#	PIC	DESCRIPTION	YEAR	PRICE
0M-13234-B	(S)	<u>Parking Light Socket &amp; Wires</u> - For turn signals - Right Side	49-50	23.75 ea.
0M-13235-B	(S)	- For turn signals - Left Side	49-50	23.75 ea.
7RA-13208	(T)	<u>Park Light Lens - Glass</u> - Right or Left	49	14.25 ea.
7RA-13211	(U)	<u>Park Light Lens to Housing Gasket</u>	49	4.75 pr.
7RA-13225	(V)	<u>Park Light Socket Rubber Boot</u>	49-50	25.00 pr.

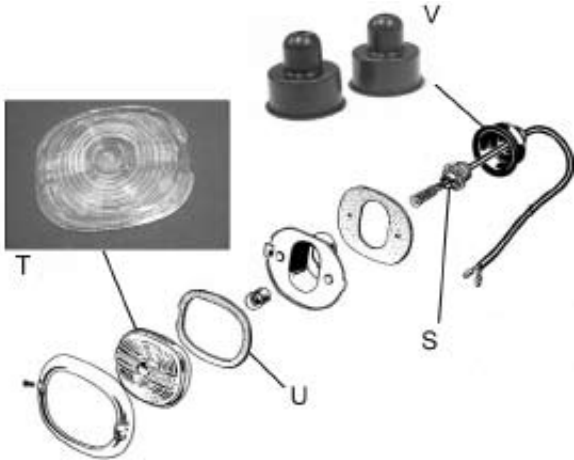

### PARK LIGHT - MERCURY 1950

PART#	PIC	DESCRIPTION	YEAR	PRICE
0M-13234-B		<u>Parking Light Socket &amp; Wires</u> - For turn signals - Right Side	49-50	23.75 ea.
0M-13235-B		- For turn signals - Left Side	49-50	23.75 ea.
0M-13208	(W)	<u>Park Light Lens - Plastic</u> - Right or Left	1950	11.40 ea.
0M-13211	(X)	<u>Park Light Lens to Housing Gasket</u>	50	5.70 pr.
7RA-13225	(Y)	<u>Park Light Socket Rubber Boot</u>	49-50	25.00 pr.
0M-13244	(Z)	<u>Park Light to Fender Seal</u>	50	5.70 pr.

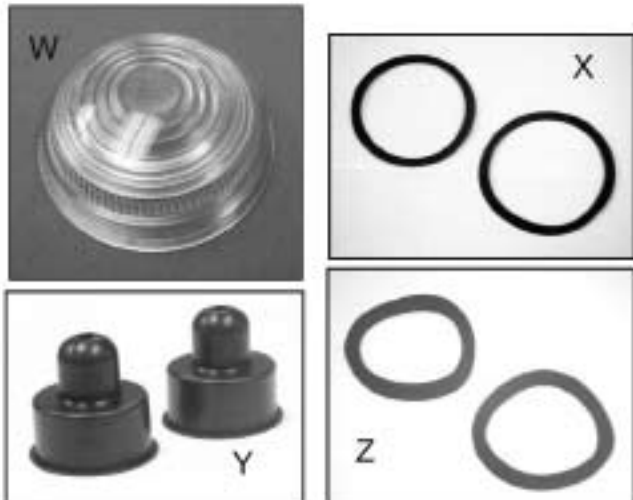

### HEADLIGHT PARTS

PART#	PIC	DESCRIPTION	YEAR	PRICE
11A-13044	(U)	<u>Headlight Bucket To Fender Gasket</u>	41-56	3.80 ea.
0A-13076	(W)	<u>Headlight Bucket Wire</u> - Rubber Covered	49-51	19.00 ea.
11A-13076	(W)	- Replacement - Cloth Covered	49-51	19.00 ea.

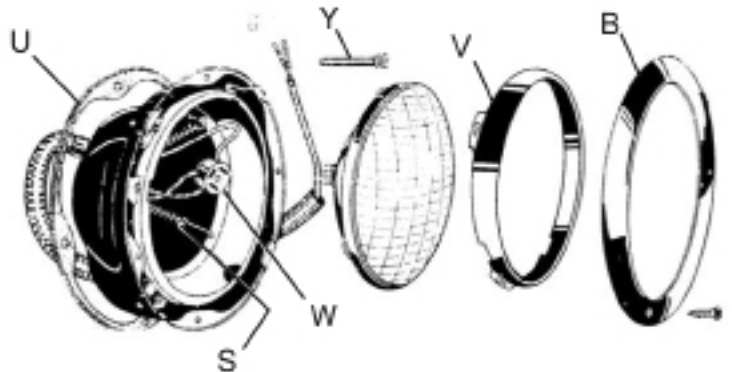

### PARK LIGHT - MERCURY 1951

PART#	PIC	DESCRIPTION	YEAR	PRICE
1M-13208		<u>Park Light Lens</u> - Right - Ford Script	51	38.00 ea.
1M-13209	(A)	- Left - Ford Script	51	38.00 ea.
1M-13211	(B)	<u>Park Light Lens to Housing Gasket</u>	51	4.75 pr.

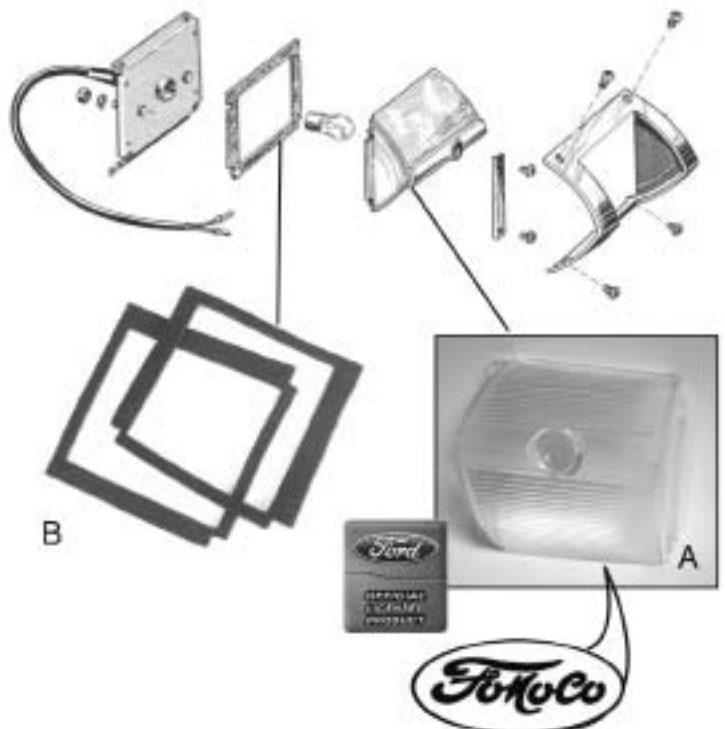

### TAILLIGHT LENS - MERCURY - 49-50

PART#	PIC	DESCRIPTION	YEAR	PRICE
8M-13450-A		<u>Taillight Lens - Glass</u> - RH - Except Wagon	49-50	23.75 ea.
8M-13451-A	(Q)	- LH - Except Wagon	49-50	23.75 ea.
8M-13450-BD	(R)	<u>Taillight Lens w/ Blue Dot</u> - Glass - RH - ex. Wagon	49-50	33.25 ea.
8M-13451-BD		- Glass - LH - ex. Wagon	49-50	33.25 ea.
8M-13461	(S)	<u>Taillight Lens to Housing Seal</u>	49-50	6.65 pr.
8M-13420	(T)	<u>Taillight Housing to Body Pads</u> - ex. Wagon	49-50	19.00 pr.
8M-13453	(U)	<u>Taillight Housing to Body Seal</u> - ex. Wagon	49-50	8.00 pr.

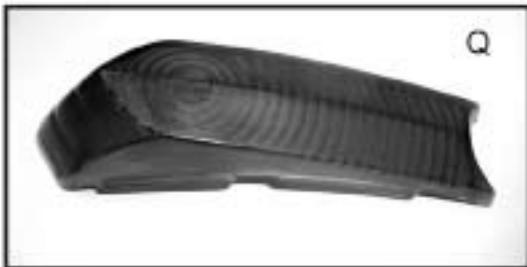
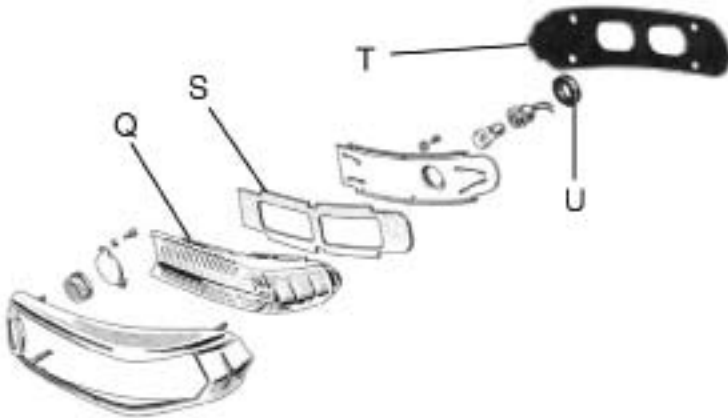

### TAILLIGHT LENS - MERCURY - 1951

PART#	PIC	DESCRIPTION	YEAR	PRICE
1M-13450	(V)	<u>Taillight Lens</u> - Plastic - RH or LH - Except Wagon	51	60.00 ea.
1M-13461	(W)	<u>Taillight Lens to Housing Seal</u>	51	7.60 pr.
MP 1009-J	(X)	<u>Taillight Housing to Body Pads</u> - Except Wagon	51	26.75 pr.

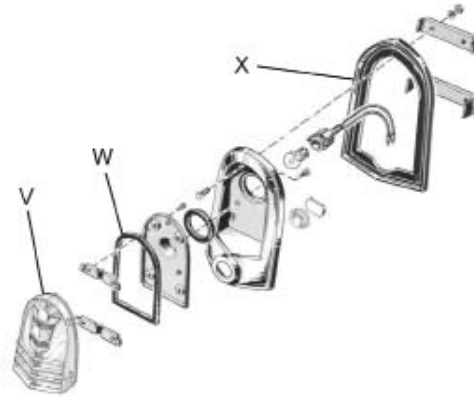

### TAILLIGHT REFLECTORS - MERCURY

PART#	PIC	DESCRIPTION	YEAR	PRICE
8M-13437	(Y)	<u>Taillight Reflectors</u> Round, Red Plastic	49-50	14.25 pr.
1M-13437		<u>Taillight Reflectors</u> Round, Red Plastic	51-53	14.25 pr.



### GROMMETS FOR FIREWALL

PART#	PIC	DESCRIPTION	YEAR	PRICE
8A-14603-B		<u>Main Wiring Loom Grommet</u>	49-51	3.80 ea.
8A-14608	(O)	<u>Main Wiring Grommet Retainer</u> - Original Tooling	49-59	9.50 ea.
B-14605-A		<u>Air Vent Cable Grommet</u>	49-51	1.90 pr.



### WIPER HOSE & MOTOR PARTS

PART#	PIC	DESCRIPTION	YEAR	PRICE
99A-17543	(L)	<u>Wiper Hose - 1/4" I.D.</u> - NON RETURNABLE - Sold by the Foot	32-60	0.75 ft.
8A-17545-S	(K)	<u>Wiper Hose Grommet</u>	49-51	2.85 ea.
51A-17562	(J)	<u>Wiper Arm to Motor Grommet</u>	49-51	1.90 ea.



### BRAKE & CLUTCH PEDAL PARTS

PART#	PIC	DESCRIPTION	YEAR	PRICE
8A-2456-B	(N)	<u>Brake Pedal Retracting Spring</u> - Convertible & Wagon - Use with X type frame	50-51	9.00 ea.
CB 90	(P)	<u>Clutch &amp; Brake Pedal Pads</u> - Standard Trans.	49-51	15.65 ea.
8M-2476	(S)	<u>Clutch &amp; Brake Pedal Arm Seals</u>	49-51	23.75 pr.
91A-7523		<u>Brake Pedal Return Spring</u>	49-51	4.50 ea.

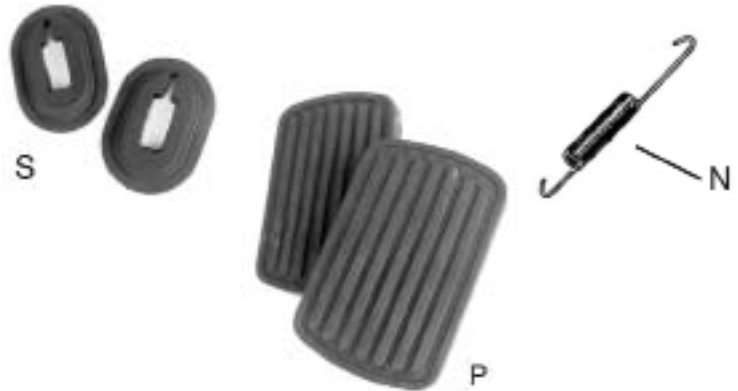

### GEAR SHIFT PARTS

PART#	PIC	DESCRIPTION	YEAR	PRICE
1M-7246-A		<u>Gear Shift Insulator - Rubber</u> - Automatic Trans.	51-53	7.60 ea.

# RUBBER

*the Right Way*

## QUESTIONS?

CALL (866) 789-7879  
or EMAIL [sales@rubbertherightway.com](mailto:sales@rubbertherightway.com)

### WINDSHIELD RUBBER - FRONT

PART#	PIC	DESCRIPTION	YEAR	PRICE
<b>For Cars WITH SINGLE Groove for Chrome</b>				
8M-7003110	(A)	Front Windshield Rubber - All body styles ex. Wagon	49-51	85.50 ea.
8M-7903110-A	(A)	Front Windshield Rubber - Body: 79 Station Wagon	49-51	166.25 ea.

### BACK WINDOW RUBBER

PART#	PIC	DESCRIPTION	YEAR	PRICE
	(C)	Back Window Seal - w/ Groove for Chrome		
8M-7242084-B		- For one piece glass	49-50	61.25 ea.
1M-7042084		- locking strip included	51	83.15 ea.
VWS 3301-R	(C)	For 3 Piece Glass	49	245.30 kit

### VENT WINDOW SEALS - REAR DOOR

PART#	PIC	DESCRIPTION	YEAR	PRICE
8M-7021450-PR		- 4-Dr. Sed. w/ Tabs (Division Seal)	50	28.50 pr.
0M-7221450-PR		- 4 Dr. Sed. w/o Tabs (Division Seal)	50-51	23.75 pr.
8A-7030248-PR	(B)	-2 Dr. Sedan - Flip Out Style	49-51	114.00 pr.
WR 3311-R	(B)	-4 Dr. Sedans	49-51	92.70 pr.



**Quality Assured Parts**

**Made in USA**

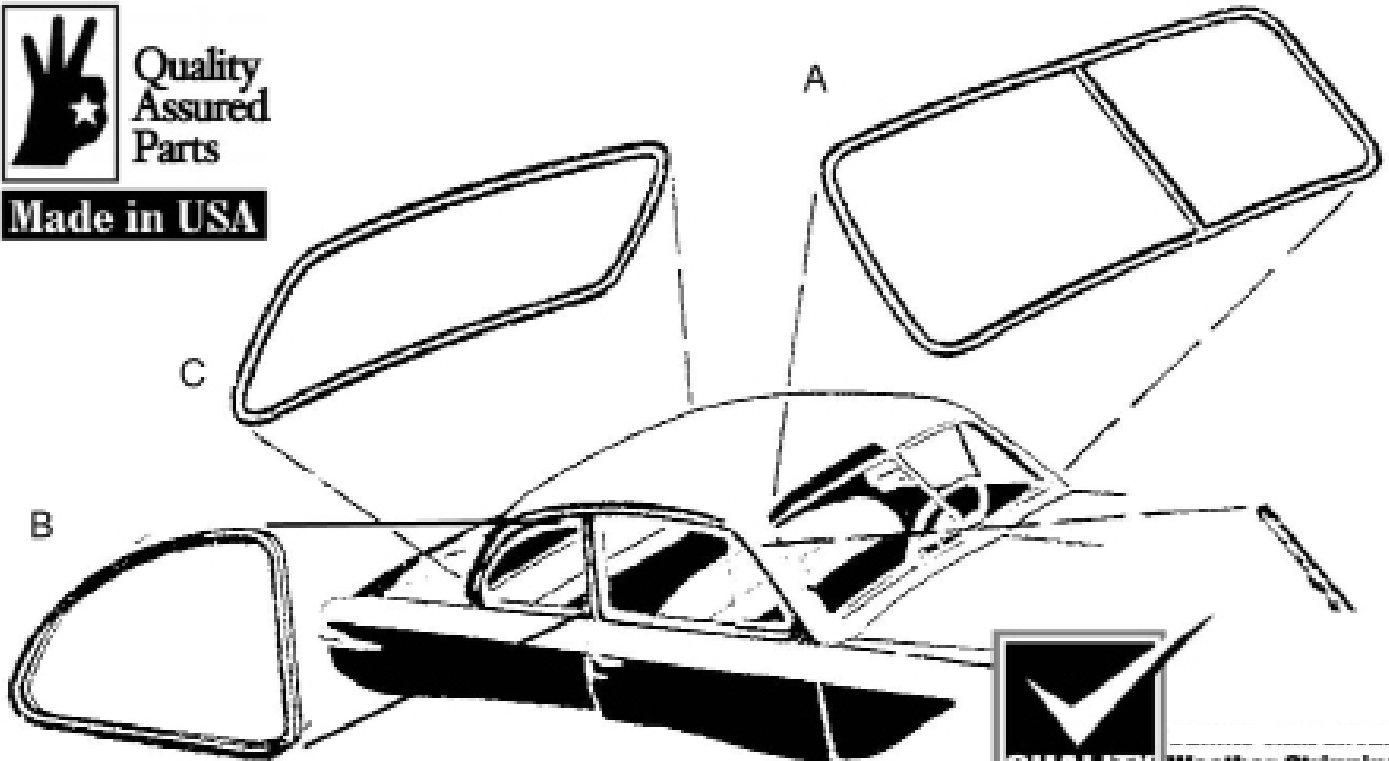

**QUALITY Weather Stripping**

*Fits Right and Lasts Longer*

### DOOR SEALS

PART#	PIC	DESCRIPTION	YEAR	PRICE
8M-7020530-PR	(A)	- 2-Dr Sedan	49-51	104.50 pr.
LM 33		- Convertible - includes bottom seals	49-51	92.15 kit
8M-7320530-SET		- 4-Dr Sedan	49-51	190.00 set
8A-7020712-PR	(D)	<u>Lower Door Seal Retainer</u> - 2 - 40" Metal Strips that hold the lower door seal to the bottom of the door	49-51	7.60 pr.

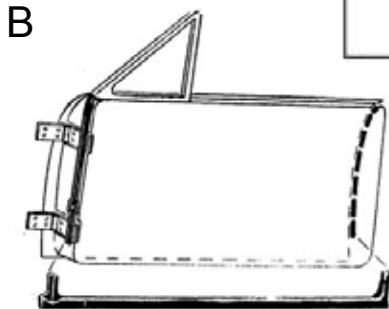
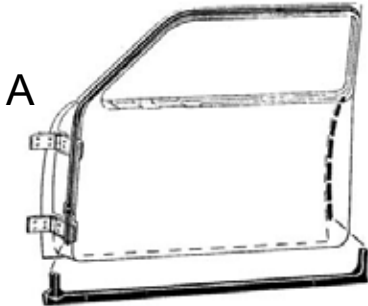

### VENT WINDOW FOOT

PART#	PIC	DESCRIPTION	YEAR	PRICE
WREX 3312	(C)	<u>Front of Vent Window Foot</u>	49-51	16.25 pr.



### VENT WINDOW SEALS - FRONT DOOR

PART#	PIC	DESCRIPTION	YEAR	PRICE
<b>WILL NOT FIT WAGONS - No Rivets Included</b>				
8M-7021448-PR	(A)	- All except Convertible & Wagons	50-51	95.00 pr.
8M-7921448-PR	(A)	- Wagons	50-51	237.50 pr.
WR 3302	(A)	- 2 Dr. & 4 Dr. Sedans	49	82.25 pr.
WR 3312	(A)	- Convertibles	49-51	91.00 pr.

### BACK EDGE VENT WINDOW SEALS - FRONT DOOR

PART#	PIC	DESCRIPTION	YEAR	PRICE
<b>WILL NOT FIT WAGONS - No Rivets Included</b>				
8M-7021450-PR	(B)	- w/ Tabs - All ex. Conv. & Wagon	49-50	28.50 pr.
0M-7221450-PR	(B)	- w/ out Tabs - All ex. Conv. & Wagon	50-51	23.75 pr.
8M-7621450-PR	(B)	- Convertible - w/ Tabs	49-51	28.50 pr.
0A-7921450-PR	(B)	- w/ Rivets - Mercury	51	28.50 ea.

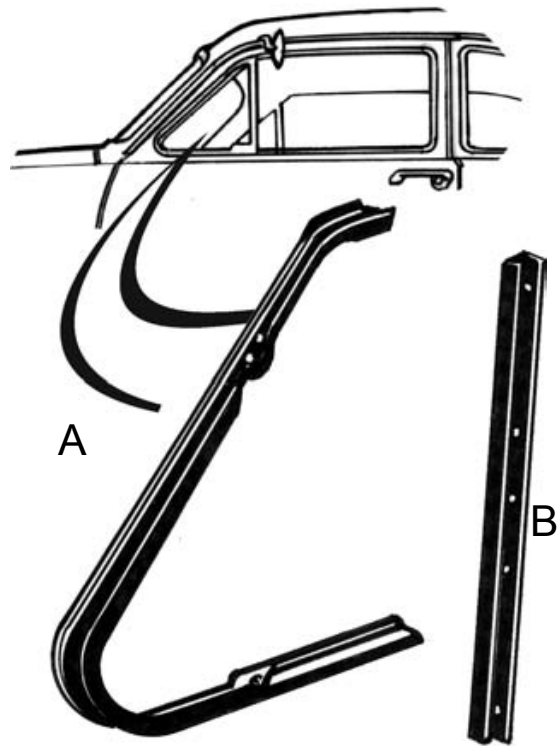

\*NOTE - The Vent Window Seal & Back Edge of Vent Window Seal are two SEPARATE items. They both must be ordered for a complete restoration of the vent window.

### ACCELERATOR PEDAL

PART#	PIC	DESCRIPTION	YEAR	PRICE
8A-9735	(K)	- All models	50-51	14.25 ea.

### GAS TANK RELATED

PART#	PIC	DESCRIPTION	YEAR	PRICE
21A-9047	(E)	<u>Filler Tank to Neck Connection Hose</u> - 2.75" X 2.18 ID	49-51	7.15 ea.
7A-9072-B		<u>Gas Tank Filler Pipe to Floor Seal</u>	49-51	9.50 ea.
		<u>Gas Tank Neck Grommet</u>		
GF 39	(I)	- All Except Wagon	49-50	10.00 ea.
0A-9080		- All Except Wagon	51	7.60 ea.
0A-9084		- Fits Wagon Only	49-51	23.75 ea.
1M-7228626		<u>Gas Tank Door Bumper</u> - Except Wagon	51	2.50 ea.

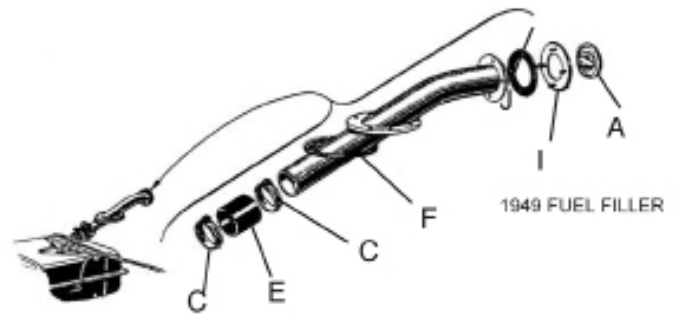

OTHER FREE CATALOGS AVAILABLE from

# RUBBER

*the Right Way*

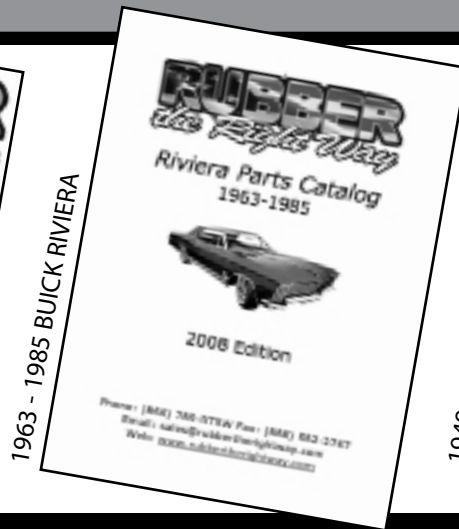

CALL (866) 789-8779 or EMAIL [sales@rubbertherightway.com](mailto:sales@rubbertherightway.com)

### STEERING TUBE TO FLOOR SEAL

PART#	PIC	DESCRIPTION	YEAR	PRICE
11A-7001730		<u>Steering Tube to Floor Seal</u>	49-51	7.60 ea.



### SUNVISOR

PART#	PIC	DESCRIPTION	YEAR	PRICE
Sunvisor is made of cardboard and is light grey in color.				
8M-7004104	(E)	All except Convertible & Wagon	49-51	28.50 ea.
8M-7604104		Convertible ONLY	49-51	28.50 ea.

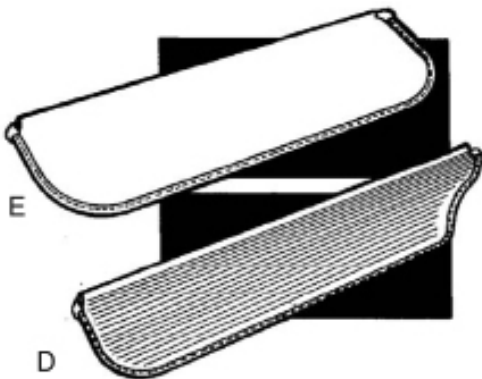

### GLOVE BOX PARTS

PART#	PIC	DESCRIPTION	YEAR	PRICE
8M-7006010		<u>Glove Box Liner</u>	49	45.00 ea.
0M-7206010		<u>Glove Box Liner</u>	50-51	23.75 ea.
RP 203-A		<u>Glove Box Check Arm Grommet</u>	49-51	4.60 ea.



### TRUNK LID & SEALS

PART#	PIC	DESCRIPTION	YEAR	PRICE
8M-7043720	(D)	<u>Trunk Lid Seal</u>	49-51	23.75 ea.

### TRUNK LID HANDLE & PADS

PART#	PIC	DESCRIPTION	YEAR	PRICE
<u>Trunk Lid Handle Pad</u>				
MP 1009-P		- Except Wagon	49	19.50 ea.
MP 1009-C		- Except Wagon	50	11.75 ea.
MP 1009-Q		- Except Wagon	51	19.50 ea.

### FACTORY SHOP MANUALS ON CD ROM

PART#	PIC	DESCRIPTION	YEAR	PRICE
SM-49MR		<u>Shop Manual CD All Models</u>	49-51	\$47.99 ea.



### ADHESIVES & REMOVERS

PART#	PIC	DESCRIPTION	YEAR	PRICE
23-001X		<u>3M SUPER Yellow Weatherstrip Adhesive - 5 oz Tube</u>		11.00 ea.
23-003X		<u>3M SUPER Black Weatherstrip Adhesive - 5 oz Tube</u>		11.00 ea.
23-002X		<u>3M Adhesive Remover - 8 oz Can</u>		13.00 ea.



**ORDERING & GENERAL INFO****PAYMENT METHODS:**

We accept Master Card, Visa, Pay Pal, check, or money order. Check and money order payments will be held until they clear. Orders can be placed by phone during our business hours, faxed, mailed, or emailed. Always contact us for an accurate shipping quote before sending payment. All of our contact information is printed on the front cover of this catalog. For your convenience, we have also included an order form on the opposite side of this page. Additional order forms can also be printed from our website.

**PARTS AVAILABILITY:**

Although we do stock most parts in our catalog, on occasion parts may be out of stock. Some of our parts are also made to order only. Out of stock & made to order parts can usually be shipped within 7-10 business days of order. HOWEVER, if time is a factor for you, please give us a call or send us an email to confirm availability & delivery time.

**SHIPPING CHARGES:**

Shipping charges will be actual ship cost, plus a small handling fee dependant upon your order. Call, fax, or email your order and we can quote shipping. We offer USPS or UPS services. We will ship international, call or email for a quote.

**RETURN POLICY:**

Rubber the Right Way offers a 100% satisfaction guarantee on ALL of our products. We place no time limit on returns, as we know the experienced restorer will order parts long before he or she will need them. There are however a few conditions on all returns.

All returns MUST be accompanied by a Rubber the Right Way sales receipt. Item(s) must be in unused condition. Item(s) do not have to be in original packaging. However, we cannot offer refunds on parts which have been installed and removed, cut, modified, etc. We suggest comparing your new product to the original before installation when possible. If no original part is available, test fit the product on a clean vehicle before any adhesive or fasteners are applied.

**PRICES:**

Prices are subject to change without notice. If unsure, please call our sales line for the latest information. We always try to maintain competitive prices, but our costs can sometimes change without notice. Part #'s, specifications, and descriptions of parts are also subject to change.



4809 Clairemont Dr. #384 • San Diego, CA 92117  
Phone (866) 789-7879 • Fax (888) 582-2767 or (858) 228-1262  
Web [www.rubbertherightway.com](http://www.rubbertherightway.com) • Email [sales@rubbertherightway.com](mailto:sales@rubbertherightway.com)

